

## Hanging scale **ZW 7.0 / 8.0**



---

Factory calibrated  
Nominal loads of 5000 kg to 10000 kg  
Measure the top load in positive  
and negative direction of force

---

Tensile or compression applications  
Weighing operations in many different fields

---

Designed,  
developed and  
made in Germany

These fully electronic scales are suited to the measurement of tensile and compression loads. They are available in different load ranges between 5000 kg and 10000 kg. The hanging scales consist of a transducer and a hand-held terminal. These are firmly connected to each other with a cable. The display of the hand-held terminal can show the current measured values as well as the peak values of both load directions.

The transducer, a shear-force load cell, is insensitive to transverse forces. So, the scales provide you with highly accurate measuring results. The transducer can be adapted in various ways with the two mounting threads. Furthermore, spherical rod ends and eyebolts are available as accessories.

You can request the firmware version, the date of the last calibration and the

serial number of your device via an easy-to-use menu. In this menu, you can also set the auto-off time for saving the batteries, the desired measuring rate and the display contrast.

Four batteries of type AA which can be easily replaced by the user supply the scales with power.

## Technical data

Type	ZW7.0 / 5000 kg	ZW7.0 / 8000 kg	ZW8.0 / 10000 kg
Nominal load [kg]	5,000	8,000	10,000
Overload	1.2x nominal load		
Display	12digits, 2 lines		
Sensitivity/display increments* [kg]	1	10	10
Accuracy	±0.25 % f.s. ** (under tension <i>or</i> compression)		
Operating temperature	0°C to +50°C		
Storage temperature	-20°C to +70°C		
Measuring rate	configurable: 10, 20 or 100 Hz		
Power supply	4 x battery type AA		
Operating time	>8h continuous operation		
Auto off time	configurable: 8, 30, 60 min / off		
Dimensions of the transducer [mm]	L 108 x W 54 x H 108	L 108 x W 54 x H 108	L 120 x W 80 x H 120
Mounting thread	2 x M24x2	2 x M24x2	2 x M30x2
Hand terminal's dimensions [mm]	L 145 x W 78 x H 44		
Material of the transducer	Steel, electropolished		
Housing of the hand terminal	ABS		
Total weight (without accessoires) [kg]	3.5	3.5	7.1
Cable	FDCP plus 4 x 0.25 mm <sup>2</sup> , length 5 m	FDCP plus 4 x 0.25 mm <sup>2</sup> , length 10 m	FDCP plus 4 x 0.25 mm <sup>2</sup> , length 5 m
Protection class of the transducer	IP 67		
Protection class of the hand terminal	IP 40		

\* other sensitivities on request

\*\* f.s. = full scale value



## Calibration

- » Factory calibrated
- » Under tension or compression
- » Display in kg

## Options

- » Mechanical overload protection for compression loads

## Accessories for ZW 7.0 / 8.0

Product	Description	Figure	
Spherical rod ends (for adaption)	BEM 25 for ZW 7.0 / 5000 kg / 8000 kg BEM 30 for ZW 8.0		○
Eyebolts (for adaption)	Thread M24x2 for ZW7.0/5000 kg Thread M30x2 for ZW8.0		○
Carrying case	Plastic material, for one scale		○
Extension connection cable	Length 5 m, including connection socket hand-held terminal		○

● requirement | ● requirement / selection | ○ optionally available

## Dimensions ZW 7.0 / 8.0 with accessories

Dimensions in mm

Transducer with spherical rod ends (optional)

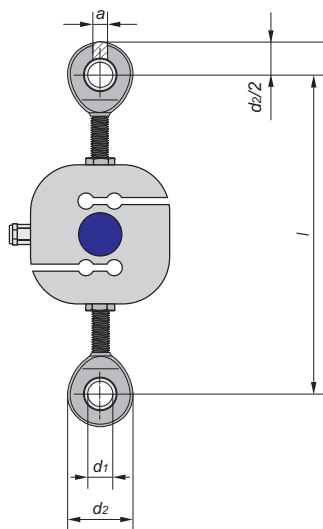

Type	ZW 7.0	ZW 8.0
a [mm]	22	25
l [mm]	241	285
d1 [mm]	25	30
d2 [mm]	60	70

Transducer with eyebolts (optional)

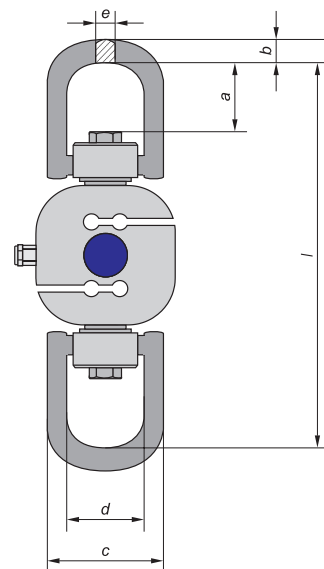

Type	ZW 7.0 / 5000 kg	ZW 8.0
a [mm]	53	69.5
b [mm]	28	34
c [mm]	139	182
d [mm]	83	114
e [mm]	24	30
l [mm]	330	408